



# Public Notice

U.S. Army Corps  
of Engineers  
Baltimore District

In Reply to Application Number  
CENAB-OP-RM (Campbell's Town Creek Boatyard LLC.)  
2017-60228

PN 17-22

Comment Period: May 9, 2017 to May 29, 2017

---

**THE PURPOSE OF THIS PUBLIC NOTICE IS TO SOLICIT COMMENTS FROM THE PUBLIC REGARDING THE WORK DESCRIBED BELOW. NO DECISION HAS BEEN MADE AS TO WHETHER OR NOT A PERMIT WILL BE ISSUED AT THIS TIME.**

This District has received an application for a Department of the Army permit pursuant to Section 10 of the Rivers and Harbors Act of 1899 33. U.S.C. 1344) as described below:

APPLICANT: Campbell's Town Creek Boatyard, LLC  
c/o Tom Campbell  
109 Myrtle Street  
Oxford, Maryland 21654

LOCATION: In the Town Creek, 107 Myrtle Street Oxford, Talbot County, Maryland.

WORK: The applicant proposes to maintenance dredge by mechanical method an approximate 137.56-foot by 396-foot area to -7.0 feet mean low water (MLW) resulting in approximately 3,026 cubic yards of silt and sand to be deposited at an existing upland (non-wetland) disposal site at 28745 Sanderstown Road Trappe, Maryland. A 10-year maintenance dredging clause is requested.

If you have any questions concerning this matter, please contact Mrs. Laura Coleman of this office at (443) 853-2051 or via email at [lamuelle.l.coleman@usace.army.mil](mailto:lamuelle.l.coleman@usace.army.mil).

The purpose of the project is to improve navigational access.

As part of the planning process for the proposed project, steps were taken to ensure avoidance and minimization of impacts to waters of the United States to the maximum extent practicable. Compensatory mitigation is not being proposed by the applicant for impacts to open water (inter-tidal and sub-tidal) habitat or to the wetlands. There are no wetlands at the proposed project activity site.

The Magnuson-Stevens Fishery Conservation and Management Act (MSFCMA), as amended by the Sustainable Fisheries Act of 1996 (Public Law 04-267), requires all Federal agencies to consult with the National Marine Fisheries Service (NMFS) on all actions, or proposed actions, permitted, funded, or undertaken by the agency that may adversely affect Essential Fish Habitat (EFH). The project site lies in or adjacent to EFH as described under Magnuson-Stevens Fishery Conservation and Management Act (MSFCMA) for Juvenile and adult Red hake (*Urophycis chuss*) and Windowpane flounder (*Scopthalmus aquosus*); Adult Atlantic sea herring (*Clupea harengus*); Juvenile and adult Bluefish (*Pomatomus saltatrix*); Eggs, larvae, juvenile and adult Atlantic butterfish (*Peprilus triacanthus*); Larvae, juvenile and adult Summer flounder (*Paralichthys dentatus*); Juvenile and adult Scup (*Stenotomus chrysops*) and Red Drum (*Sciaenops ocellatus*); Eggs, larvae, juveniles and adult King mackerel (*Scomberomorus cavalla*), Spanish mackerel (*Scomberomorus maculatus*), Cobia (*Rachycentron canadum*), Black sea bass (*Centropristus striata*) and all managed species under the MSFCMA.

The project has the potential to adversely affect EFH or the species of concern by the alteration of spawning, nursery, forage and/or shelter habitat. The project may have an adverse effect on an approximate total of 54,078 square foot area of EFH as described under the MSFCMA for the species and life stages identified above. This habitat consists of a mostly sand and silt substrate which does not support SAV. According to the Virginia Institute of Marine Science (VIMS) survey maps, there were no SAV mapped at the project footprint of the proposed activity for years 2011 through 2015 but none at the subject property. The Baltimore District has made a preliminary determination that site-specific impacts would not be substantial and an abbreviated consultation will be conducted with NMFS. No mitigative measures are recommended at this time to minimize adverse effects on EFH. This preliminary determination may be modified if additional information indicates otherwise and could change the Corps' preliminary determination.

The decision whether to issue a permit will be based on an evaluation of the probable impacts, including cumulative impacts of the proposed activity on the public interest. That decision will reflect the national concern for both protection and utilization of important resources. The benefit, which reasonable may be expected to accrue from the proposal, must be balanced against its reasonably foreseeable detriments. All factors, which may be relevant to the proposal will be considered, including the cumulative effects thereof; among those are conservation, economic, aesthetics, general environmental concerns, wetlands, cultural values, fish and wildlife values, flood hazards, flood plain values, land use, navigation, shoreline erosion and accretion, recreation, water supply and conservation, water quality, energy needs, safety, food and fiber production, mineral needs, and consideration of property ownership and in general, the needs and welfare of the people.

The Corps of Engineers is soliciting comments from the public; Federal, State, and local agencies and officials; Indian Tribes; and other interested parties in order to consider and evaluate the impacts of this proposed activity. Any comments received will be considered by the Corps of Engineers to determine whether to issue, modify, condition or deny a permit for this proposal. To make this decision, comments are used to assess impacts on endangered species, historic properties, water quality, general environmental effects, and the other public interest factors listed above.

Comments are used in the preparation of an Environmental Assessment and/or an Environmental Impact Statement pursuant to the National Environmental Policy Act. Comments provided will become part of the public record for this action. Comments are also used to determine the need for a public hearing and to determine the overall public interest of the proposed activity. Written comments concerning the work described above related to the factors listed above or other pertinent factors must be received by the District Engineer, U.S. Army Corps of Engineers, Baltimore District, 10 S. Howard Street, Baltimore, Maryland, 21201 within the comment period specified above.

Where applicable, the applicant has certified in this application that the proposed activity complies with and will be conducted in a manner consistent with the approved Coastal Zone Management (CZM) Program. By this public notice, we are requesting the State concurrence or objection to the applicant's consistency statement. It should be noted that the CZM Program has a statutory limit of 6 months to make its consistency determination.

The applicant must obtain any State or local government permits which may be required.

A preliminary review of this application indicates that the proposed work may affect but is not likely to adversely affect Federal listed threatened or endangered species or their critical habitat, pursuant to Section 7 of the Endangered Species Act, as amended. As the evaluation of this

application continues, additional information may become available which could modify this preliminary determination.

Review of the latest published version of the National Register of Historic Places indicates that no registered properties listed as eligible for inclusion, therein, are located at the site of the proposed work. Currently unknown archeological, scientific, prehistoric, or historical data may be lost or destroyed by the work to be accomplished under the request permit.

Any person who has an interest which may be adversely affected by the issuance of this permit may request a public hearing. The request, which must be in writing, must be received by the District Engineer, U.S. Army Corps of Engineers, Baltimore District, 10 S. Howard Street, 21201, within the comment period as specified above to receive consideration. Also it must clearly set forth the interest which may be adversely affected by this activity and the manner in which the interest may be adversely affected.

It is requested that you communicate this information concerning the proposed work to any persons known by you to be interested and not being known to this office, who did not receive a copy of this notice.

FOR THE DISTRICT ENGINEER:

KATHY B. ANDERSON  
Chief, Maryland Section Southern

**PERMIT DRAWINGS  
FOR  
TOM CAMPBELL  
IN THE THIRD ELECTION DISTRICT  
TALBOT COUNTY, MARYLAND**

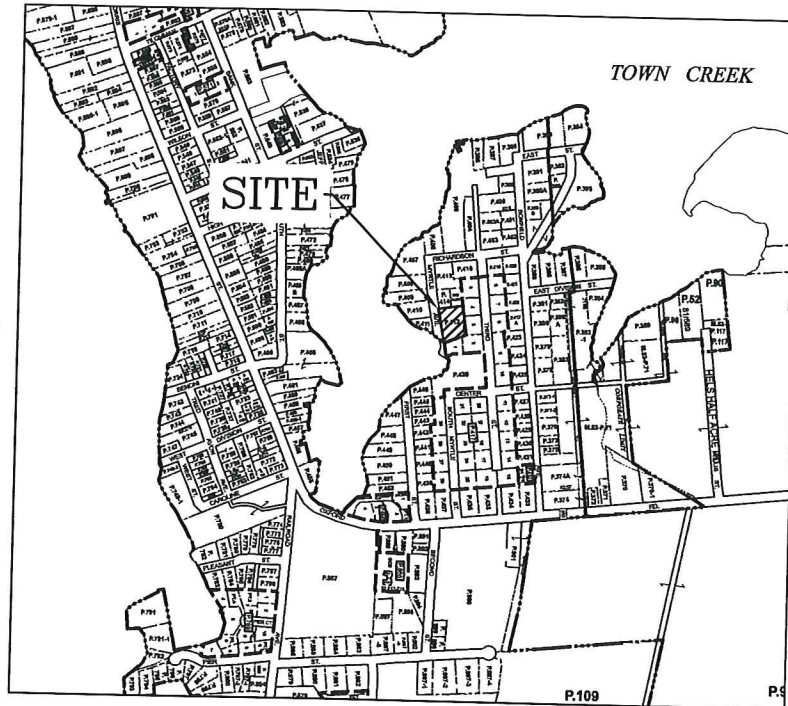

**VICINITY MAP**  
SCALE: 1" = 1,000'

**ENGINEER**

**Lane Engineering, LLC**  
117 BAY STREET  
EASTON, MARYLAND 21601  
(410) 822-8003

**OWNER/DEVELOPER**

CAMPBELL'S TOWN CREEK BOATYARD, LLC  
C/O TOM CAMPBELL  
109 MYRTLE STREET  
OXFORD, MD 21654-1268

**PROJECT LOCATION**

107 MYRTLE AVENUE  
OXFORD, MD 21654

| ISSUE FOR:   | DATE:   | BY: | No. | DATE: | REVISION: | BY: |
|--------------|---------|-----|-----|-------|-----------|-----|
| MDE APPROVAL | 1/27/17 | DSW |     |       |           |     |
|              |         |     |     |       |           |     |
|              |         |     |     |       |           |     |
|              |         |     |     |       |           |     |

SHEET NO. **1 OF 6**  
 DATE: 11/15/16  
 SCALE: AS NOTED  
 JOB No. 160104  
 FILE No. 1020

**TITLE SHEET**  
ON THE LANDS OF  
**CAMPBELL'S TOWN CREEK BOATYARD**  
OXFORD, MARYLAND  
IN THE THIRD ELECTION DISTRICT, TALBOT COUNTY  
TAX MAP 400 GRID 10 PARCEL 412

**Lane Engineering, LLC**  
Established 1986  
Civil Engineers • Land Planning • Land Surveyors



E-mail: general@leinc.com  
 117 Bay St. Easton, MD 21601 (410) 822-8003  
 15 Washington St. Cambridge, MD 21613 (410) 221-0818  
 354 Pennsylvania Ave. Centerville, MD 21617 (410) 758-2095



# LEGEND & ABBREVIATIONS

MLW MEAN LOW WATER (ELEVATION)  
 MHW MEAN HIGH WATER (ELEVATION)  
 MLWL MEAN LOW WATER LINE  
 MHWL MEAN HIGH WATER LINE

PROPERTY LINE 

CONTOUR LINE  -24-

SPOT ELEVATION x -2.15

SPARTINA ALTERNIFLORA ↓

SPARTINA PATENS ↓↓

MHHW = 1.83

MHW = 1.62

MSL = 0.80

MLW = 0.00

MLLW = -0.21

NAVD 88 = 0.90

NGVD 29 = 0.16



## NOTES:

1. TIDAL DATUM, I.E. MEAN LOW WATER ELEVATION, IS ESTIMATED FROM ENVIRONMENTAL INDICATORS SUCH AS RACK LINES, WATER MARKS, PLANT COMMUNITY COMPOSITIONS.
2. UNLESS OTHERWISE NOTED, ELEVATIONS SHOWN HEREIN ARE REFERENCED TO MEAN LOW WATER (MLW) = 0.0'.
3. THERE ARE EXISTING PIERS ON THE ADJOINING PROPERTIES TO THE NORTH AND SOUTH.
4. MEAN TIDAL RANGE = 1.62'
5. LOT SIZE = 0.55 AC±
6. LOT DEPTH = 137'±
7. LOT WIDTH AT SHORELINE = 38'±
8. DISTANCE TO CHANNEL CENTERLINE = 396'±
9. MAXIMUM CHANNELWARD ENCROACHMENT = 447'±
10. ZONING CLASSIFICATION = C-3 MARITIME COMMERCIAL
11. 911 ADDRESS = 107 MYRTLE AVENUE OXFORD, MD 21654

## VERTICAL DATUM COMPARISON CHART

SCALE: 1"=1'

NOTE: MEAN LOW WATER (MLW) AND RELATIVE TIDAL INFORMATION WAS OBTAINED FROM THE NATIONAL OCEANIC AND ATMOSPHERIC ADMINISTRATION (NOAA) AND THE NATIONAL OCEANIC SERVICE (NOS) AND ARE BASED UPON TIDAL BENCH MARK CAMBRIDGE (STATION ID: 8571892) TIDAL EPOCH 1983-2001.

AT THE APPLICANT'S REQUEST, THE PROPERTY LINE INFORMATION SHOWN ON THIS PLAN, WITH LATERAL LINES, SETBACKS AND SHORELINE ARE TAKEN FROM DEED, PLAT AND AERIAL PHOTO INTERPRETATION, AS WELL AS, FIELD WORK COMPLETED BY LANE ENGINEERING, LLC AUGUST 2016 AND MARINE PERMIT DRAWINGS PREVIOUSLY PREPARED BY LANE ENGINEERING, LLC DATED 9/24/02. THE SOUNDINGS SHOWN HEREON WERE TAKEN AUGUST 2016. A PROPERTY LINE SURVEY WAS NOT PERFORMED. THE INFORMATION SHOWN HEREON WAS TAKEN FROM 1972 1"=200' STATE OF MARYLAND WETLANDS MAPS, AERIAL PHOTOGRAPHS, TAX MAPS AND A SITE SKETCH. THESE MAPS ARE BELIEVED TO BE THE BEST, READILY AVAILABLE SOURCE OF INFORMATION FOR MARINE PERMITTING PURPOSES. A DETAILED ONSITE SURVEY FOR THE PURPOSE OF ACCURATELY DETERMINING EXISTING FEATURES INCLUDING PROPERTY LINES, SHORELINES, EXISTING PIERS, OTHER STRUCTURES, AND SOUNDINGS HAS NOT BEEN COMPLETED. LANE ENGINEERING IS NOT RESPONSIBLE FOR ANY INACCURACIES ASSOCIATED WITH THE LOCATION OF ABOVE REFERENCED EXISTING FEATURES AND RELATED LATERAL LINES, SETBACKS, ETC. THIS SKETCH IS FOR PERMIT PURPOSES ONLY AND IS NOT TO BE USED AS AN ACCURATE CONSTRUCTION DOCUMENT.

|                                                                      |                                                                                                                                                                                                                                                                        |                                                                                                                                                                                                                                                                                                                                                                                                         |
|----------------------------------------------------------------------|------------------------------------------------------------------------------------------------------------------------------------------------------------------------------------------------------------------------------------------------------------------------|---------------------------------------------------------------------------------------------------------------------------------------------------------------------------------------------------------------------------------------------------------------------------------------------------------------------------------------------------------------------------------------------------------|
| SHEET No.<br><b>2 OF 6</b>                                           | <b>SITE &amp; PROJECT NOTES</b><br><br><b>ON THE LANDS OF</b><br><b>CAMPBELL'S TOWN CREEK BOATYARD</b><br><b>OXFORD, MARYLAND</b><br><br><b>IN THE THIRD ELECTION DISTRICT, TALBOT COUNTY</b><br><b>TAX MAP 400 GRID 10 PARCEL 412</b>                                 | <b>Lane Engineering, LLC</b><br><br>Established 1986<br>Civil Engineers • Land Planning • Land Surveyors<br><br><br>E-mail: general@leinc.com<br>117 Bay St. Easton, MD 21601 (410) 822-8003<br>15 Washington St. Cambridge, MD 21613 (410) 221-0818<br>354 Pennsylvania Ave. Centreville, MD 21617 (410) 758-2095 |
| DATE: 11/15/16<br>SCALE: AS NOTED<br>JOB No. 160104<br>FILE No. 1020 | Date: 01/27/2017 - 8:18am User: dwalton Project Manager: JSC Drawing Path: C:\Swap\AcPublish_5788\HMP-PLTS-160104.dwg   Sheet2<br>XREF File(s): CBS-BASE-160104/RAR-BASE-160104/RD-BASE-160104/VSF-BASE-160104/CSP-BASE-160104/CPR-SRCE-160104 © LANE ENGINEERING, LLC |                                                                                                                                                                                                                                                                                                                                                                                                         |



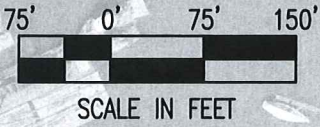
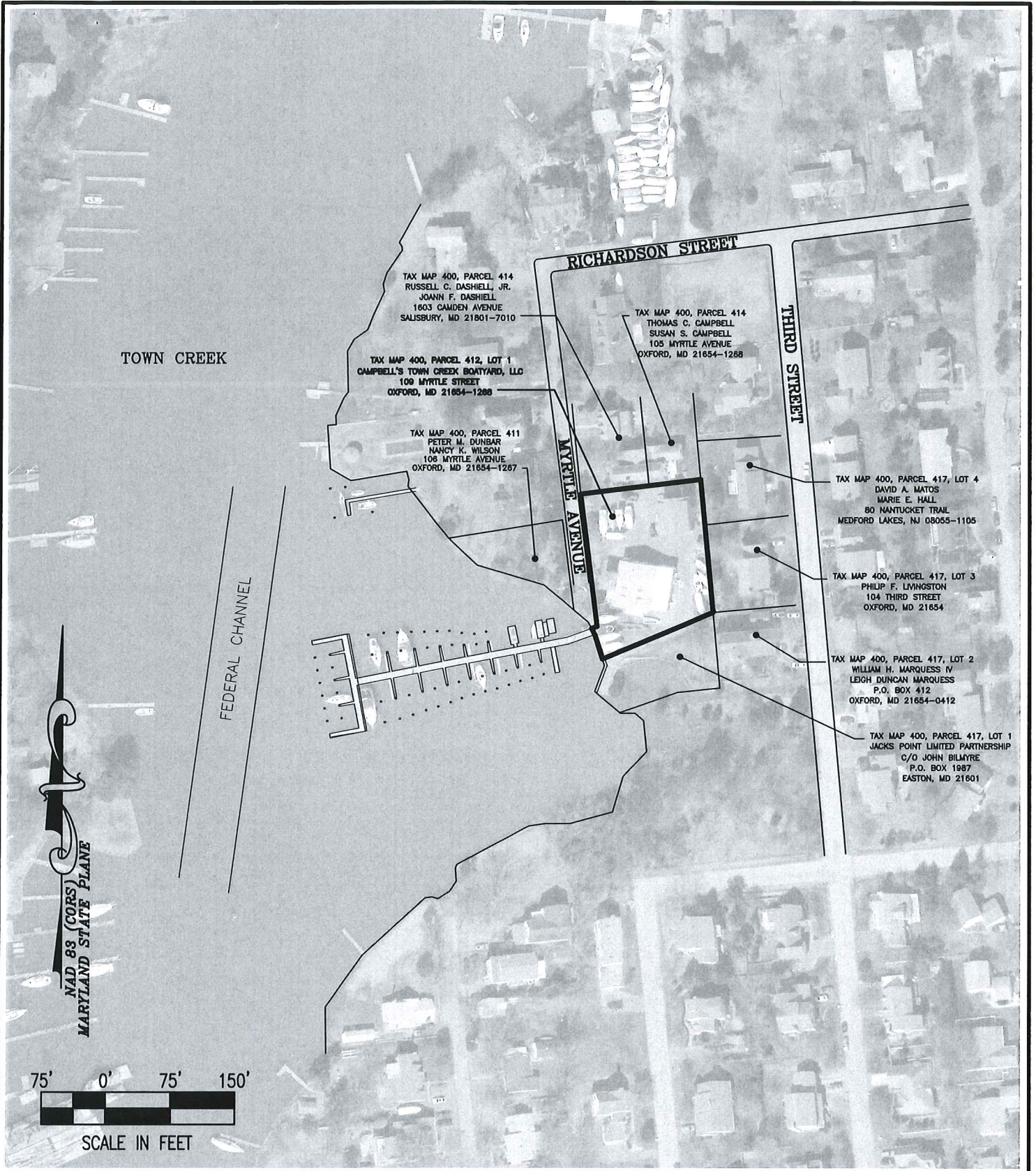

SHEET No.  
**3 OF 6**  
 DATE: 11/15/16  
 SCALE: AS NOTED  
 JOB No. 160104  
 FILE No. 1020

**SITE OVERVIEW**  
**ON THE LANDS OF**  
**CAMPBELL'S TOWN CREEK BOATYARD**  
**OXFORD, MARYLAND**  
 IN THE THIRD ELECTION DISTRICT, TALBOT COUNTY  
 TAX MAP 400 GRID 10 PARCEL 412

**Lane Engineering, LLC**  
 Established 1986  
 Civil Engineers • Land Planning • Land Surveyors

  
 E-mail: general@leinc.com  
 117 Bay St. Easton, MD 21801 (410) 822-8003  
 15 Washington St. Cambridge, MD 21813 (410) 221-0818  
 354 Pennsylvania Ave. Centreville, MD 21617 (410) 758-2095



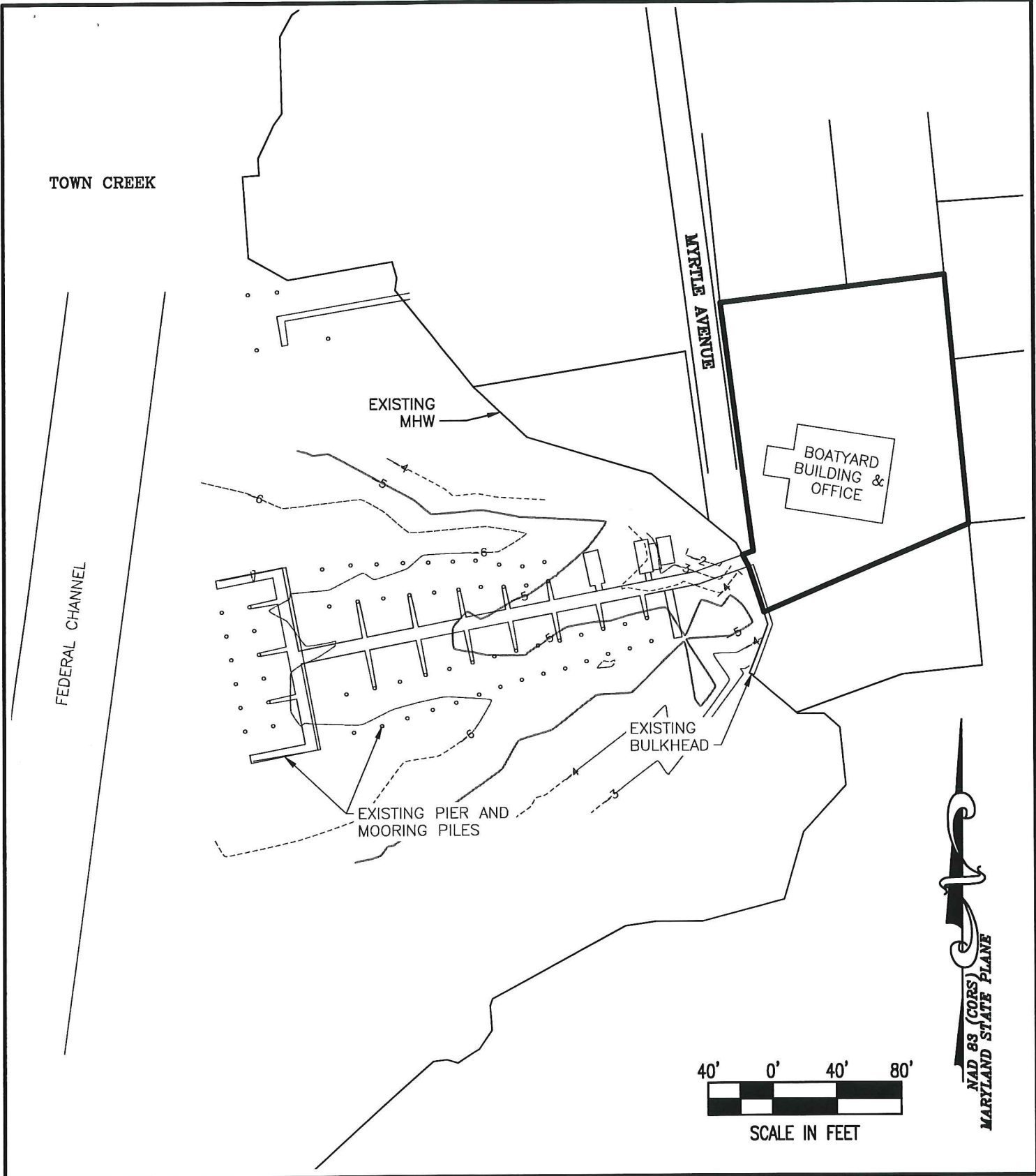

NAD 83 (CORS)  
 MARYLAND STATE PLANE

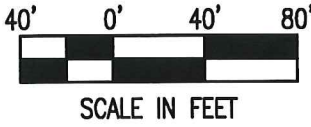

SHEET No.  
**4 OF 6**  
 DATE: 11/15/16  
 SCALE: AS NOTED  
 JOB No. 160104  
 FILE No. 1020

**EXISTING CONDITIONS**  
**ON THE LANDS OF**  
**CAMPBELL'S TOWN CREEK BOATYARD**  
**OXFORD, MARYLAND**  
 IN THE THIRD ELECTION DISTRICT, TALBOT COUNTY  
 TAX MAP 400 GRID 10 PARCEL 412

**Lane Engineering, LLC**  
 Established 1986  
 Civil Engineers • Land Planning • Land Surveyors

  
 E-mail: general@leinc.com  
 117 Bay St. Easton, MD 21601 (410) 822-8003  
 15 Washington St. Cambridge, MD 21613 (410) 221-0818  
 354 Pennsylvania Ave. Centreville, MD 21617 (410) 758-2095

© LANE ENGINEERING, LLC

TOWN CREEK

MYRTLE AVENUE

BOATYARD  
BUILDING &  
OFFICE

FEDERAL CHANNEL

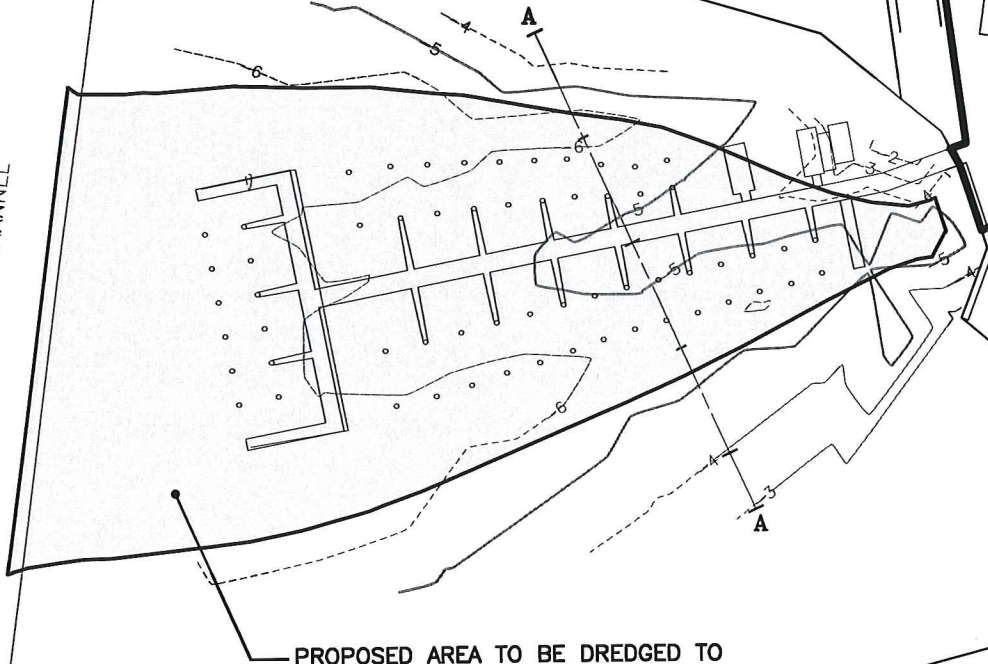

PROPOSED AREA TO BE DREDGED TO  
A DEPTH OF -7.0' (54,473 SF±)

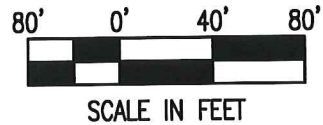

FILE No. 1020  
 JOB No. 160104  
 SCALE: AS NOTED  
 DATE: 11/15/16  
 SHEET No.  
**5 OF 6**

**PROPOSED IMPROVEMENTS**  
**ON THE LANDS OF**  
**CAMPBELL'S TOWN CREEK BOATYARD**  
**OXFORD, MARYLAND**

IN THE THIRD ELECTION DISTRICT, TALBOT COUNTY  
 TAX MAP 400 GRID 10 PARCEL 412

**Lane Engineering, LLC**

Established 1986  
 Civil Engineers • Land Planning • Land Surveyors



E-mail: general@leinc.com  
 117 Bay St. Easton, MD 21801 (410) 822-8003  
 15 Washington St. Cambridge, MD 21613 (410) 221-0818  
 354 Pennsylvania Ave. Centerville, MD 21617 (410) 758-2095



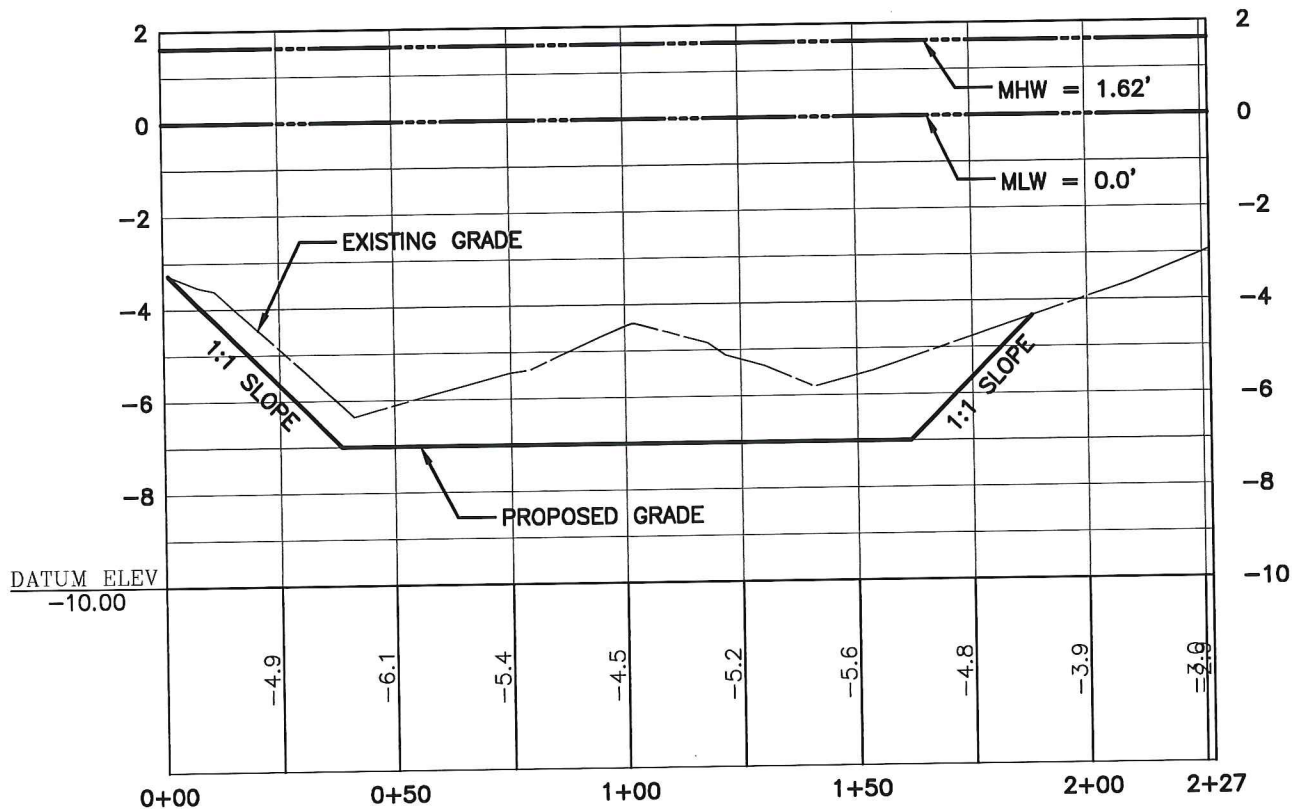

**SECTION A-A**  
 HORIZONTAL SCALE: 1" = 40'  
 VERTICAL SCALE: 1" = 4'

SHEET No.  
**6 OF 6**

DATE: 11/15/16  
 SCALE: AS NOTED  
 JOB No. 160104  
 FILE No. 1020

**DETAILS**

**ON THE LANDS OF  
 CAMPBELL'S TOWN CREEK BOATYARD  
 OXFORD, MARYLAND**

**IN THE THIRD ELECTION DISTRICT, TALBOT COUNTY  
 TAX MAP 400 GRID 10 PARCEL 412**

**Lane Engineering, LLC**

Established 1986  
 Civil Engineers • Land Planning • Land Surveyors



E-mail: general@leinc.com  
 117 Bay St. Easton, MD 21601 (410) 822-8003  
 15 Washington St. Cambridge, MD 21613 (410) 221-0818  
 354 Pennsylvania Ave. Centreville, MD 21617 (410) 758-2095